



High-quality anti-corrosion protection of the used metal elements guarantees durability and long-term stability of the entire plasterboard construction. All elements in the PROFIFIX system are protected against corrosion under normal climatic conditions and in full compliance with current standards. In case of increased demands on structures used in outdoor environments, swimming pools, saunas or other areas with permanent humidity, it is necessary to increase the corrosion protection and thus strengthen the longevity of the entire structure.

For your satisfaction, safety and longevity of your buildings, the PROFIFIX brand brings to the market certified construction elements and accessories for plasterboard suspended systems according to EN 13964:2014 and EN 14195:2014. These parts excel in additional anti-corrosion treatment of used materials according to EN ISO 12944-2:2017 and EN ISO 9223:2012. Their quality has been tested and confirmed by an independent testing laboratory.

Average loss of zinc layer on accessories without additional corrosion protection when used in highly corrosive areas with a direct environmental impact on the components.

### Approximate annual loss of zinc layer (%)

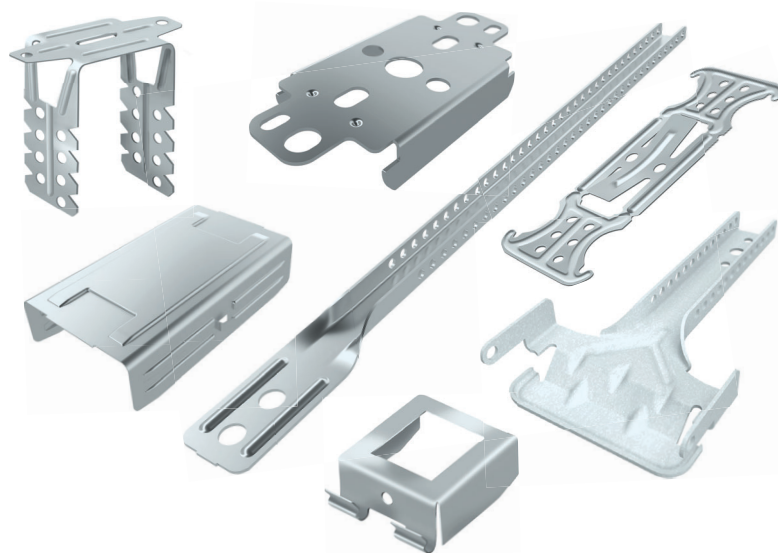
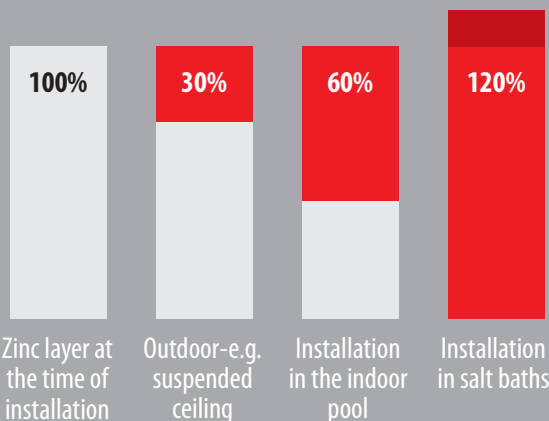

Product code	Product name	Packing (pcs)	Pcs in carton	Pcs on pallet
31806C	C5 - Straight ceiling suspension - 60/0,8 mm	100	-	15000
31812C	C5 - Straight ceiling suspension - 120/0,8 mm	100	-	15200
31120C	C5 - Straight ceiling suspension 200	100	-	9600
49001C	C5 - Direct hanger Klick fix	100	-	5000
41002C	C5 - Cross straight connecting piece	100	-	21000
41105C	C5 - CD Profile longitudinal connector - straight 100	100	-	6000
41004C	C5 - Level connector CD	100	-	6000
48008C	C5 - Nonius bottom part CD with security clamp	100	-	-
48016C	C5 - Nonius hanger upper part 160 mm	100	-	-
48026C	C5 - Nonius hanger upper part 260 mm	100	-	-
48036C	C5 - Nonius hanger upper part 360 mm	100	-	-
48046C	C5 - Nonius hanger upper part 460 mm	50	-	-
48056C	C5 - Nonius hanger upper part 560 mm	50	-	-
48066C	C5 - Nonius hanger upper part 660 mm	50	-	-
48076C	C5 - Nonius hanger upper part 760 mm	50	-	-
48086C	C5 - Nonius hanger upper part 860 mm	50	-	-
48096C	C5 - Nonius hanger upper part 960 mm	50	-	-