

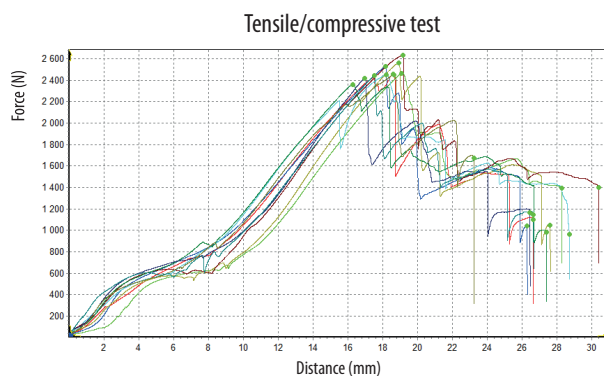

NEW MODEL

- Modified design to enable more comfortable handling and assembly.
- Increase in load capacity due to widening and reinforcement of surfaces in stress areas.
- Increased stiffness through mouldings.
- Strengthened resistance to mechanical pressure and tension.



 **910 N / 91 Kg**
LOAD BEARING CAPACITY
 **852 N / 85 Kg**

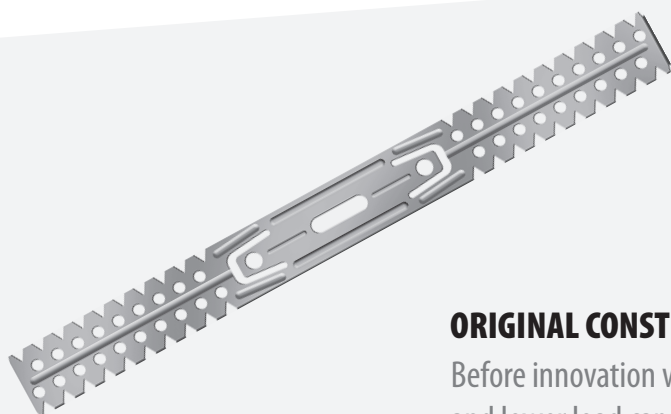

ORIGINAL CONSTRUCTION

Before innovation with sharp edges and lower load capacity.

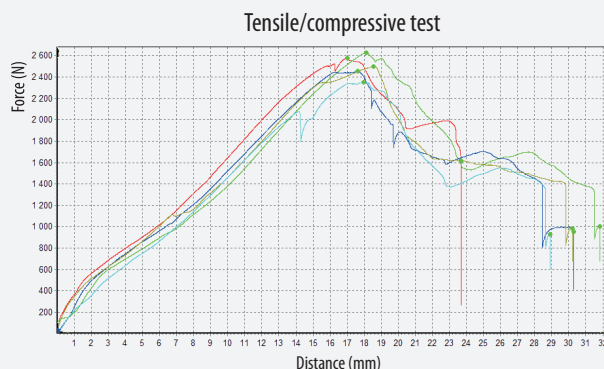



CD Profile longitudinal connector - straight 100

CD connector straight is metal connecting element designed for plaster-board construction made by compression molding from steel, hot-dip galvanized sheet. The protrusions on the both sides define and determine the correct depth for inserting the connector into the CD profile.

Use

CD connector is used to join and extend CD profiles. Assembly is performed by simple sliding into the profile.

The coupling does not serve as a support hinge and therefore cannot be used for connections by adjacent profiles at the same level, to maintain the strength and load-bearing capacity of the structure.

Product code	Product name	Packing (pcs)	Pcs in carton	Pcs on pallet	Material	Coating EN 10327	Load-bearing capacity DIN 18168-2	Reaction to fire	Corrosion protection	Hazardous substances
41100	CD Profile longitudinal connector - straight 100	100	-	6000	DX51	min. Z100	NPD	A1	B	NPD
41100s	DIY CD Profile longitudinal connector - straight 100	15	-	-	DX51	min. Z100	NPD	A1	B	NPD

The product should be stored in a dry, thermally stable and tempered environment to prevent moisture condensation on the product surface.



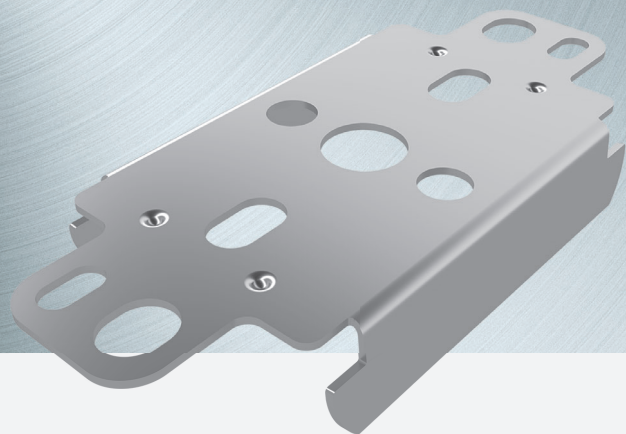

Direct hanger Klick Fix

Direct hanger Klick Fix is metal suspension element designed for plaster-board construction, made by compression molding from hot-dip galvanized steel sheet and designed for easy click into CD profile.

Use

The Direct hanger Klick Fix is used for tight anchoring of CD profiles to the supporting structure of the ceiling using screws, nail plugs or ceiling nails.

It is simply clicked into the CD profile and is designed for cases in which no further reduction of the ceiling is required or desired.

Product code	Product name	Packing (pcs)	Pcs in carton	Pcs on pallet	Material	Coating EN 10327	Load-bearing capacity DIN 18168-2	Reaction to fire	Corrosion protection	Hazardous substances
49001K	Direct hanger Klick Fix	100	-	5000	DX51	min. Z100	0,40 kN	A1	B	NPD

The product should be stored in a dry, thermally stable and tempered environment to prevent moisture condensation on the product surface.



Product list



TN - PROFIX drywall screw

The TN - PROFIX drywall screw - black/grey phosphate, fine thread, groove PH2, bugle head, the marking is according to TMN standard.

Use

The TN screws are designed for mounting plasterboard into thin-walled profiles with maximum thickness 0,7 mm.



Product code	Product name	Packing (pcs)	Pcs in carton	Pcs on pallet	Material	Coating	Flexural strength	Corrosion protection	Reaction on fire	Hazardous substances
77025	TN 25 - PROFIX drywall screw	1000	16000	384000	steel	grey/black phosphate	pass	48	A1	NPD
77035	TN 35 - PROFIX drywall screw	1000	12000	288000	steel	grey/black phosphate	pass	48	A1	NPD
77045	TN 45 - PROFIX drywall screw	500	8000	192000	steel	grey/black phosphate	pass	48	A1	NPD
77055	TN 55 - PROFIX drywall screw	500	6000	144000	steel	grey/black phosphate	pass	48	A1	NPD
77065	TN 65 - PROFIX drywall screw	500	4000	96000	steel	grey/black phosphate	pass	48	A1	NPD
77070	TN 70 - PROFIX drywall screw	250	3000	72000	steel	grey/black phosphate	pass	48	A1	NPD
77075	TN 75 - PROFIX drywall screw	250	3000	72000	steel	grey/black phosphate	pass	48	A1	NPD
77080	TN 80 - PROFIX drywall screw	250	3000	72000	steel	grey/black phosphate	pass	48	A1	NPD
77090	TN 90 - PROFIX drywall screw	250	3000	72000	steel	grey/black phosphate	pass	48	A1	NPD
77120	TN 120 - PROFIX drywall screw	500	-	-	steel	grey/black phosphate	pass	48	A1	NPD
77140	TN 140 - PROFIX drywall screw	500	-	-	steel	grey/black phosphate	pass	48	A1	NPD
77225	TN / 250 - 25 mm	250	8000	192000	steel	grey/black phosphate	pass	48	A1	NPD
77235	TN / 250 - 35 mm	250	8000	192000	steel	grey/black phosphate	pass	48	A1	NPD
77245	TN / 250 - 45 mm	250	6000	144000	steel	grey/black phosphate	pass	48	A1	NPD
77255	TN / 250 - 55 mm	250	6000	144000	steel	grey/black phosphate	pass	48	A1	NPD
77125	TN / 100 - 25 mm	100	10800	259200	steel	grey/black phosphate	pass	48	A1	NPD
77135	TN / 100 - 35 mm	100	8800	211200	steel	grey/black phosphate	pass	48	A1	NPD
77145	TN / 100 - 45 mm	100	6400	153600	steel	grey/black phosphate	pass	48	A1	NPD
77155	TN / 100 - 55 mm	100	4800	115200	steel	grey/black phosphate	pass	48	A1	NPD

The product should be stored in a dry, thermally stable and tempered environment to prevent moisture condensation on the product surface.

INNOVATION

PROFI**FIX**®

Collated screws - TN/TX



NEW EFFICIENT WAY

- Fastening collated screws saves time and significantly increases work efficiency and productivity
- Unified belts are suitable for all types of electric screwdrivers
- The most used types of screws are TN/TX
- Certified quality – throughput of screws under 0,4 seconds
- Package – 1000 pcs of screws/pack



AVAILABLE TYPES/DIMENSIONS (50 pcs of screws / per belt)

TN 3,5x25

TN 3,5x35

TN 3,5x45

TN 3,5x55

TX 3,5x25

TX 3,5x35

TX 3,5x45

ORIGINAL INSTALLATION METHOD

Significantly slower way of assembly by individual screws and more difficult manipulation



www.profix.eu



DN 6 - Ceiling anchor - 6 x 40

DN6 - ceiling anchor with a diameter of 6 mm and a length of 40 mm, consists of a steel body with an inserted thorn, which after hammering the anchor into the pre-drilled hole, fulfills the function of a wedge. The surface of both parts is galvanized to increase mechanical and corrosion resistance. The anchor is easy and quick to install.

Use

The ceiling anchor is used for anchoring to ceiling structures made of solid materials, e.g. in stone, solid brick and concrete or reinforced concrete of strength classes C20 / 25 to C50 / 60 with cracks and without cracks according to EN 206-1, also for anchoring in structures where a fire resistance is required. It is suitable for fastening parts of suspended ceilings, wires with eyelets, strips, metal profiles, ventilation distributors or wooden slats. Not suitable for anchoring in hollow materials. The product should be stored in a dry, thermally stable and tempered environment to prevent moisture condensation on the product surface.

Product code	Product name	Packing (pcs)	Pcs in carton	Pcs on pallet	Material	Coating	Flexural strength	Corrosion protection	Reaction on fire	Hazardous substances
81640	DN 6 - Ceiling anchor - 6x40	100	2000	80000	Steel	galvanized	NPD	NPD	A1	NPD



FIRE RESISTANCE

R 120

Installation instructions

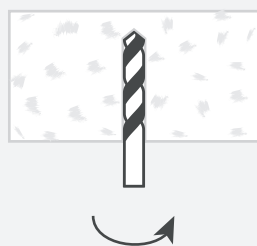

1

Drill a Ø 6 mm hole of the required length.

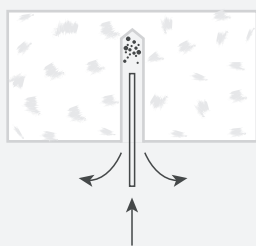

2

Blow out dust from the hole.

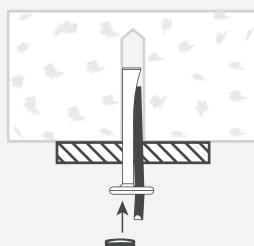

3

Insert the ceiling anchor through the anchored material and push it into the hole by tapping the head of the anchor.

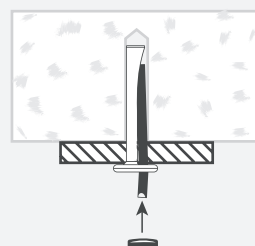

4

Completely hammer in the anchor thorn.

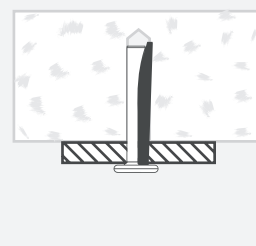

Good job!

Product list

Acoustic tape - double - sided

The acoustic tape for drywall construction is used for acoustic separation of each element from supporting structure and for reduction of vibration transmission. It is made from polyethylene foam and has self-adhesive layer on both sides for better fixation before assembly. It is supplied in reels.

Use

It is used as a connection seal that is stuck on metal profiles of drywall construction. In addition, the double-sided adhesive tape can also be used for joining profiles in double column walls, or as an assembly aid for temporarily attaching profiles before screwing them on. The width of the tape is determined by the width of the profile for assembly.

Basic technical information

Material:	polyethylene
Glue:	rubber adhesive
Tensile strength:	longitudinal: 0,42 N/mm ² (DIN 53571) transverse: 0,34 N/mm ² (DIN 53571)
Fire resistance:	B1 (DIN 4102)
Density:	29 kg/m ³ (DIN 53420)
Temperature resistance:	-30°C - +80°C
Application temperature:	> +5°C
Storage:	> +5°C, without light, chemical vapors and humidity
UV resistance:	limited
Tolerance (width):	+ - 10%
Tolerance (thickness):	+ - 10% according to the temperature
Tolerance (length):	+ 3%

Product code	Product name	Packing carton (pcs)	Pcs on pallet	Roll (m)
90330	Acoustic tape for profile 30 (30x3mm) double - sided	34	408	30
90345	Acoustic tape for profile 50 (45x3mm) double - sided	20	240	30
90365	Acoustic tape for profile 75 (65x3mm) double - sided	14	168	30
90390	Acoustic tape for profile 100 (90x3mm) double - sided	10	120	30

PROFI^{FOIL} UNIVERSAL ADHESIVE

FOR VAPOUR BARRIERS, EXPANDED POLYSTYRENE,
METALS, INSULATION AND FOAM MATERIALS, LEATHER, TEXTILES,
CARDBOARD, WOOD, VENEERS, ...



6 setting options
**SPECIAL
NOZZLE**

- **High yield** (1.2 m² per 100 ml)
- **Fast gluing**
- **Odourless**
- **Precise application**



www.profix.eu

PROFI^{FIX}

FLEX tape

Plasterboard Tape that you have been looking for!

For inside and outside corners / window and door reveals / wall and ceiling cracks

Flex Tape is an innovative composite tape designed to strengthen the corners of drywall structures, window and door reveals and it repairs cracks in the plaster. A mixture of cotton fibers and finishing additives is applied, ensuring excellent adhesion to gypsum compound sealants.

Why to choose **FLEX** tape ?

- No tearing, twisting or air bubbles
- Creates clean and straight lines
- Water and moisture resistance
- Strong and durable tape
- Adapts to any angle
- Cracks prevention
- Accelerates work

PROFI^{FIX}



www.profix.eu



FLEX tape

Flex Tape is an innovative composite tape perforated on sides designed to strengthen the inside and outside corners of drywall structures. Its supporting core consists of a flexible and at the same time durable plastic film, on which a mixture of cotton fibers and finishing additives is applied, ensuring excellent adhesion to gypsum compound sealants.

Width	Tensile strength at break	Elongation at break	Adhesion of sealant	Application temperature	Roll length
50 mm	$\geq 12,0 \text{ N/mm}^2$	$\geq 5,0 \%$	$\geq 0,25 \text{ N/mm}^2$	$\geq 10 \text{ }^\circ\text{C}$	12m / 25 m

Use

The tape is a more technologically advanced and stronger successor of paper tapes, glass and glass-textile tapes and meshes. It is used to reinforce corner joints of plasterboard structures. It is also suitable for reinforcing and repairing cracks in walls and ceilings.

Thanks to its stability when exposed to moisture, it is suitable for use in kitchens and bathrooms.

Product code	Product name	Packing (pcs)	Pcs in carton	Pcs on pallet
92009	FLEX tape 50mm x 25m	1	18	864
92010	FLEX tape 50mm x 12m	1	12	1200

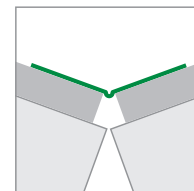
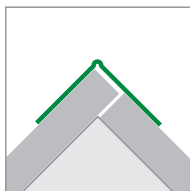

T-FLEX tape

T-Flex Tape is an innovative composite tape perforated on sides designed to strengthen the flat and inside corner joints of drywall structures. Its supporting core consists of a flexible and at the same time durable plastic film, on which a mixture of cotton fibers and finishing additives is applied, ensuring excellent adhesion to gypsum compound sealants.

Width	Tensile strength at break	Elongation at break	Adhesion of sealant	Application temperature	Roll length
50 mm	$\geq 7,0 \text{ N/mm}^2$	$\geq 5,0 \%$	$\geq 0,25 \text{ N/mm}^2$	$\geq 10 \text{ }^\circ\text{C}$	12m / 25 m

Use

The tape is a more technologically advanced and stronger successor of paper tapes, glass and glass-textile tapes and meshes. It is used to reinforce flat and inside corner joints of plasterboard structures. It is also suitable for reinforcing and repairing cracks in walls and ceilings.

Thanks to its stability when exposed to moisture, it is suitable for use in kitchens and bathrooms.

Product code	Product name	Packing (pcs)	Pcs in carton	Pcs on pallet
92011	T-FLEX tape 50mm x 25 m	1	18	864
92012	T-FLEX tape 50 mm x 12 m	1	12	1200

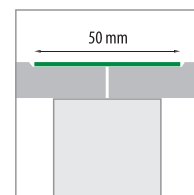
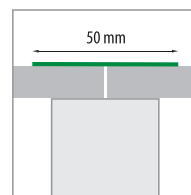
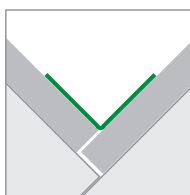

NEW PRODUCT
in the offer

PROFI**FIX**®

Fiberglass tape **FibaFuse Double Strong**

Plasterboard joints
and crack repairs



- Suitable for automatic and manual application
- Ideal for high-strength boards
- The perfect solution for cut and mitered joints
- Easy repair of unsealed areas
- Compatible with powder and paste fillers
- Easy to cut
- 76% stronger than paper tape
- Does not create blisters and bubbles
- Resistant to moisture and mold
- Compatible with automatic and manual tape unwinders
- Application with a minimal amount of filler

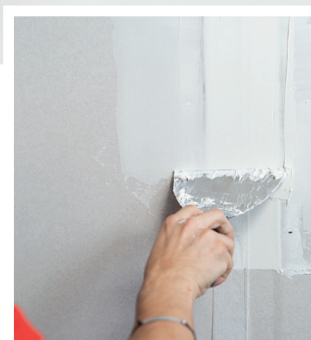
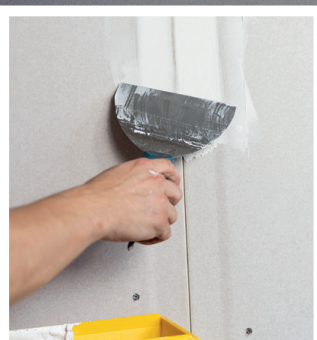



Separation strip Trennfix

Trennfix is a paper tape with a smooth, non-stick finish, provided with a 10 mm wide self-adhesive strip on the inside.

It serves for the separation of interconnected building elements in drywall construction, where it effectively prevents the formation of typical jagged cracks at the joints between the individual building elements.

Use

Trennfix tape is used as a separation tape when connecting plasterboard structures to solid ones and ensures their sliding separation. During the mutual movement of the building components, there is a controlled, straight detachment, which is not perceived as visually disturbing.

Trennfix tape is attached on to the existing wall next to the already installed profile, it can also be used together with acoustic tape attached to the profile.

Surfaces must be dry, free of dust and grease before application. After applying and drying the putty, the remaining part of the paper strip can be easily and cleanly cut off, thus creating a permanently functional connection of the building components.

It is necessary to store at temperature of 18 - 25 °C for 24 hours before application.

Basic technical information:

Width:	50 mm
Length:	50 m
Thickness:	50 µm
Adhesive type:	hotmelt adhesive
Amount of adhesive:	45 - 50 g / m ²
Width of the adhesive layer:	9-10 mm
Width tolerance:	Max. - 1,5 mm
Length tolerance:	Max. - 2%

Product code	Product name	Packing (pcs)	Pcs in carton	Pcs on pallet
91550	Separation strip Trennfix 50mm	1	36	1944
91565	Separation strip Trennfix 65mm	1	24	1296

Store in the original packaging, in a dry and clean room, away from sources of heat and sunlight, at a temperature of 15 - 24 °C and a relative humidity of 30 - 70%. Storage time up to 6 months from the date of delivery.

PE-Foam separation tape

PE-Foam separation tape is a foam tape with one sided self-adhesive lateral strip. It is made of polyethylene foam, is fine-pored, easily adaptable and resistant to aging.

It reduces the formation of stress cracks, compensates inequalities, prevents the formation of thermal and acoustic bridges.

Use

The separation tape is mainly used in drywall construction when connecting walls and ceilings to create elastic or expansion joints. Tape is also used in the plastering area to seal joints or to bridge structural tensions between larger components.

When applying, cut the required length and glue it to a dry and dust-free surface.

After cutting off the excess tape, a clean joint is created.

Basic technical information

Material:	Polyethylen
Width:	50 mm
Roll length:	30 m
Thickness:	3 mm
Adhesive type:	hotmelt adhesive
Density:	29kg/m ²
Temperature resistance:	-40 °C to +80 °C
Water absorption:	1%

Product code	Product name	Packing (pcs)	Pcs in carton	Pcs on pallet
90530	PE-Foam separation tape 30mm	1	35	525
90550	PE-Foam separation tape 50mm	1	20	300

Store at room temperature to maintain full adhesion.

Storability: dry at room temperature - 1 year